



Dial Gauge, Lug Back, ISO Type

10mm, 0,01mm

Item number: 2046A



Description

Standard Type, 10 mm Range, 0,01 mm Graduation

This is a standard, metric dial indicator. It offers you the following benefits:

- Bezel clamp and lifting lever (optional) can be attached to either right or left side. They can be easily installed and removed without tools.
- No through screw holes on the frame and secure adhesion between the bezel and the crystal as well as the use of an O-ring prevents water or oil penetration.

Features

Range:	10 mm
Range per rev.:	1 mm
Graduation:	0.01 mm
Scale:	0-100 (100-0)
MPE any 1/10 revolution:	5 µm
MPE any 1/2 revolution:	9 µm
MPE any 1 revolution:	10 µm
MPE measuring range:	13 µm
H MPE (Hysteresis):	3 µm
R MPE (Repeatability):	3 µm
Measuring force:	0,4-1,4 N
Mass:	144 g
Continuous dial:	Yes
Digital/Analog:	Analog
Inch-Metric:	Metric
Type:	EN ISO Standard
Stem:	8 mm
Contact point:	Carbide tipped, thread: M 2.5 x 0.45 mm
Delivered:	with certificate of inspection

Dimensions

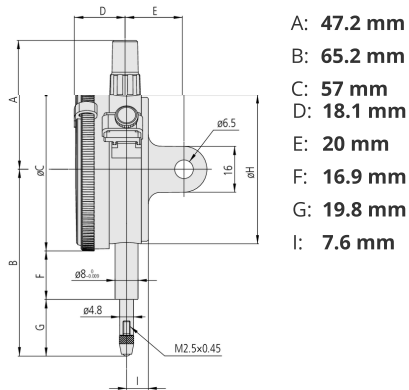

Optional accessories:



Limit Hands (green) 2pcs
Dial Indicator Series 2/3/4
21AZB195
Price on application



Bezel Clamp for Dial Gauge
Metric, Series 2/3/4
21AZB148
 Price on application



Spindle Lifting Lever
for Digital Indicator, A-Type Dial Indicator Series 2/3/4
21EZA198
Price on application



**Spindle Lifting Cable
for Indicator, L=500mm
21JZA295**
Price on application



**Spindle Lifting Cable with Auto Stop
for Indicator, L=300mm
21JZA301**
Price on application

Spare parts

Consumable spares:



**Contact Element Ball Point, M2,5x0,45
7,3mm Length, Carbide, Metric
901312**